

## Porous Plastic Silencer

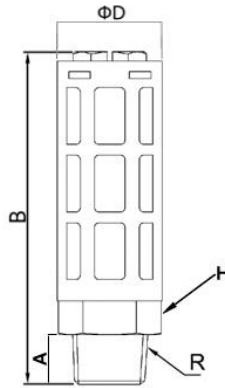

Body (noise absorbing material): Polyethylene  
Base (thread): Acetal Plastic

Working Pressure: 0—1.0MPa | 0—150psi  
Proof Pressure: 3.0Mpa | 435psi  
Negative Pressure: -100Kpa | -29.5 In Hg  
Working Temperature: 0~60°C | 32~140°F

PART NO.	Sound Pressure Level*	R	A(mm)	H(mm)	B(mm)	D(mm)
PSU 01	78	R1/8	6.5	15	40	16
PSU 02	80	R1/4	10	18	65	21
PSU 03	85	R3/8	12.5	21	85	25
PSU 04	88	R1/2	14	23	94	30
PSU 06	90	R3/4	16	33	100	45
PSU 08	95	R1	17	33	100	45
PSU M5	75	M5 x 0.8	5	14	18	8.5
PSU G01	78	G1/8	6.5	15	40	16
PSU G02	80	G1/4	10	18	65	21
PSU G03	85	G3/8	12.5	21	85	25
PSU G04	88	G1/2	14	23	94	30
PSU G06	90	G3/4	16	33	100	45
PSU G08	95	G1	17	33	100	45

\* Sound pressure level measured at 6 bar at 1 m distance.

\*\* Information contained herein may be changed without prior notification.